













LEGEND:

-  PROPERTY BOUNDARY/SECTION LINE (≈636 ACRES)
-  PERMIT BOUNDARY (250 ACRES)
-  30' SETBACK BOUNDARY
-  EXISTING TOPOGRAPHY (20 FT. INTERVALS)
-  CROSS SECTION LOCATION (SEE FIGURE 6)
-  PERMANENT MARKERS (LINE OF SIGHT)
-  EXISTING ROAD & CENTERLINE
-  SITE ACCESS ROAD
-  IRRIGATION CHANNEL & FLOW DIRECTION
-  INTERMITTENT SWALE & FLOW DIRECTION
-  25' BUFFER
-  PROPOSED PRODUCT STOCKPILE AREA (≈22 ACRES)
-  PROPOSED CRUSHER AREA (≈1 ACRE)
-  PROPOSED TOPSOIL STOCKPILE AREA (≈16 ACRES)

NOTES:

1. EXISTING AND PROPOSED BASE MAP FEATURES (PERMIT BOUNDARY, ROADS, STREAMS, DRAINAGES, ETC.) BASED ON ECOLOGICAL LAND SERVICES, INC. SITE RECONNAISSANCE, AUGUST, 2006.
2. EXISTING FEATURES WERE FIELD RECORDED BY HANDHELD GPS UNIT AND HAVE NOT BEEN SURVEYED BY A PROFESSIONAL LAND SURVEYOR.
3. EXISTING TOPOGRAPHY OBTAINED FROM USGS TOPOGRAPHIC MAP, (ELLENSBURG NORTH QUADRANGLE, 1958, PHOTOREVISED 1978) PROVIDED BY MAPTECH, INC. SOFTWARE TERRAIN NAVIGATOR PRO.

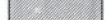
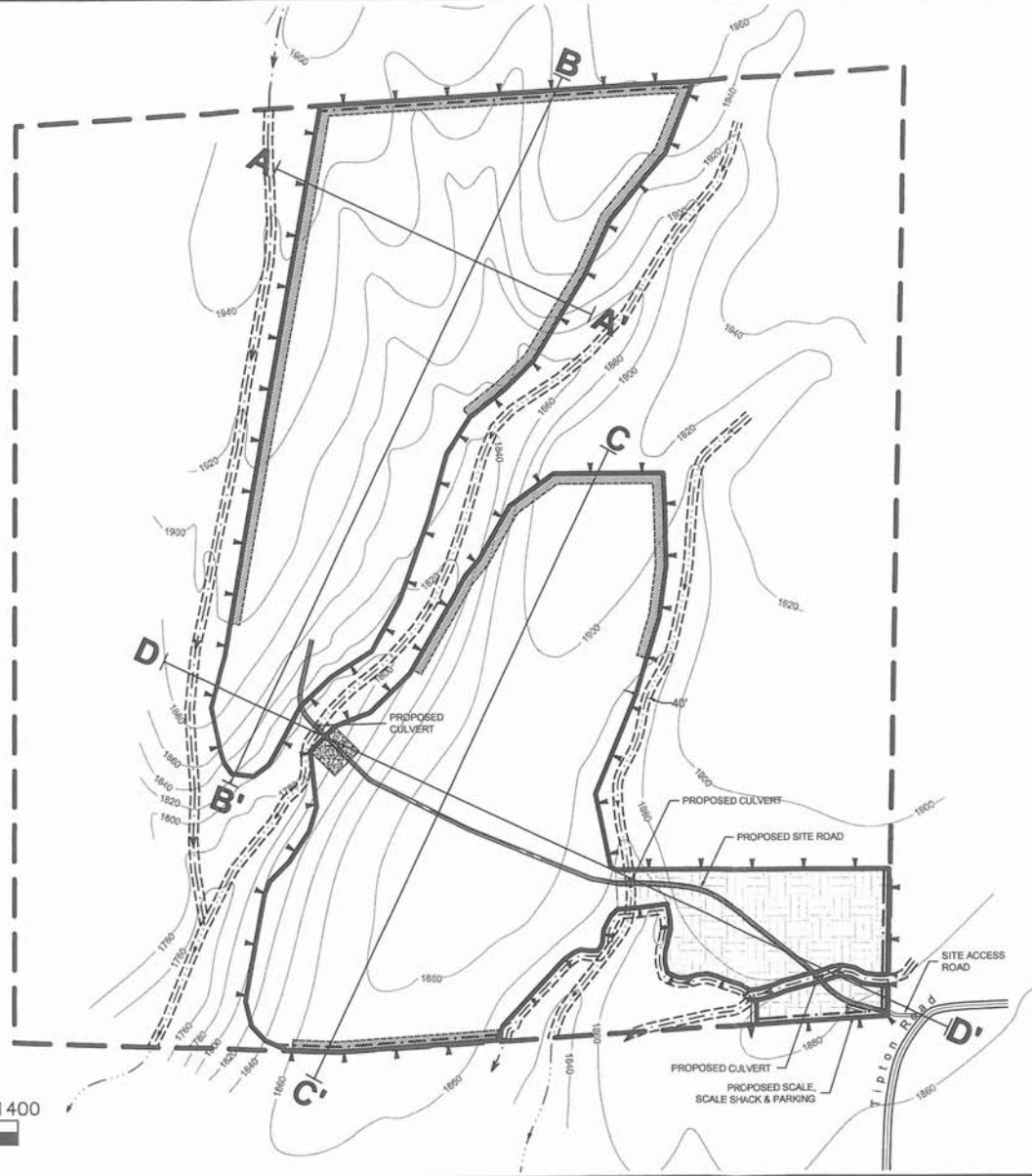

Reclamation Figure 3
 EXISTING TOPOGRAPHY MAP
 Van De Graaf Pit
 Midvale Rock Products
 Kittitas County, Washington
 Section 11, Township 18N, Range 18E, W.M.

DATE 02-19-07
 DWN. MEM
 APPR. RG
 PROJ. # 1360.02

ECOLOGICAL LAND SERVICES, INC.
 1187 3rd Ave., Suite 220 Longview, WA 98632
 (360) 578-1371 Fax: (360) 414-9305

LEGEND:

- PROPERTY BOUNDARY/SECTION LINE (=636 ACRES)
- PERMIT BOUNDARY (250 ACRES)
- ADJACENT PROPERTY PARCEL LINES
- #636033** ASSESSOR'S PARCEL NUMBER (SEE TABLE BELOW)

PROPERTY OWNERSHIP INFORMATION	
PARCEL NUMBER	OWNER NAME & ADDRESS
636033 379433 016033 486033 456033	DICK VAN DE GRAAF JR. 1691 MIDVALE RD SUNNYSIDE, WA 98944
466033 446033 436033 596033 15745	DICK VAN DE GRAAF ETUX 1691 MIDVALE RD SUNNYSIDE, WA 98944
835436	R.R & R.D. VAN DE GRAAF 1691 MIDVALE RD SUNNYSIDE, WA 98944
086033	VAN DE GRAAF RANCHES, INC. 1691 MIDVALE RD SUNNYSIDE, WA 98944
146033 951875	KERRY KLOCKNER 16512 107th PL NE BOTHELL, WA 98001
951683	DONAL S. GERARD 393 NINA LN EASTSOUND, WA 98245

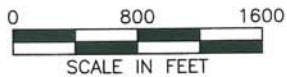

NOTES:

1. PARCEL LINES AND PROPERTY INFORMATION OBTAINED ONLINE PROVIDED BY KITTITAS COUNTY AT WEB ADDRESS [HTTP://WWW.CO.KITTITAS.WA.US](http://www.co.kittitas.wa.us).
2. AERIAL PHOTOGRAPH (2005) OBTAINED ONLINE FROM GOOGLE EARTH PRO.

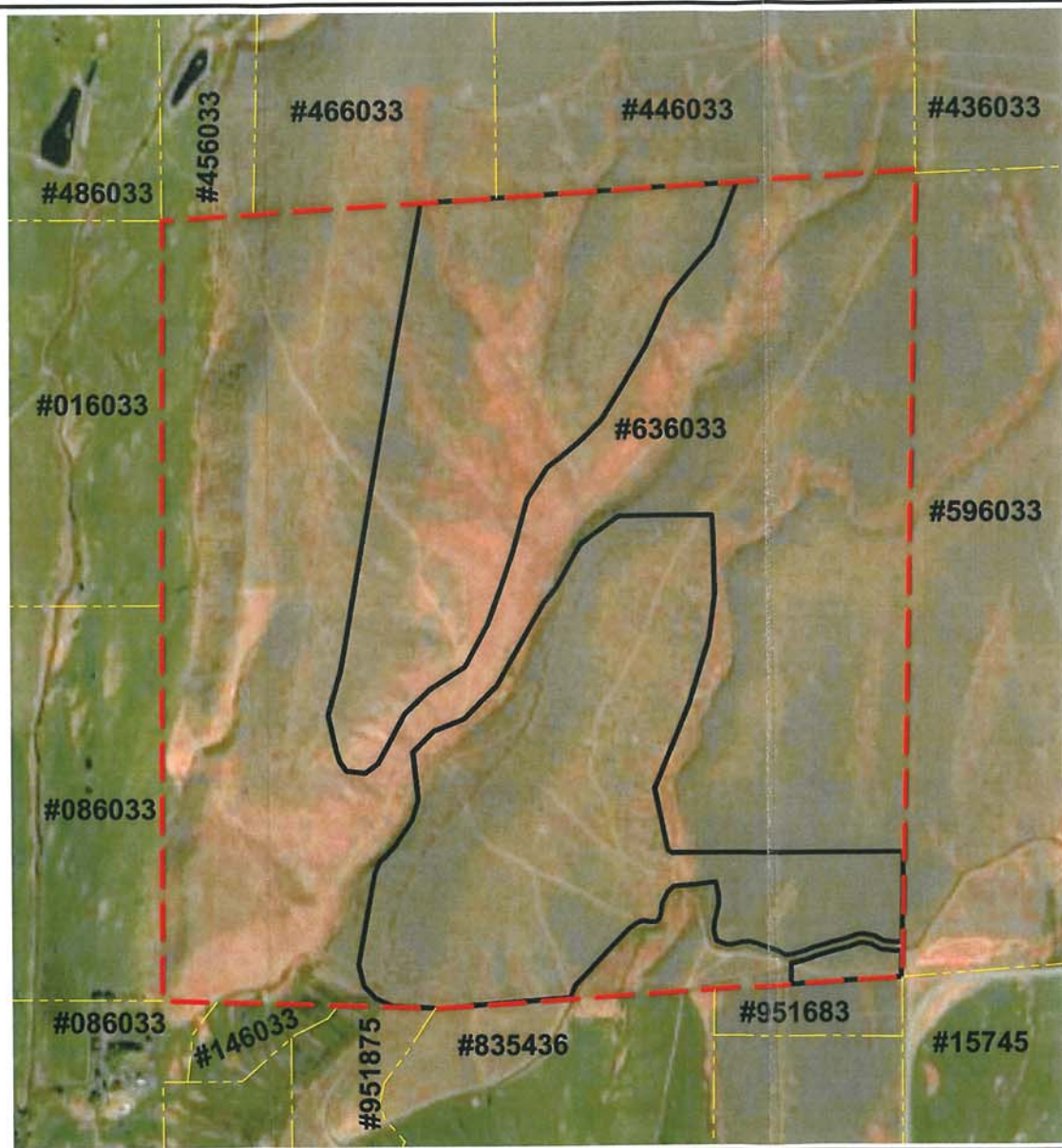









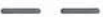

Reclamation Figure 2
 ADJACENT PROPERTY MAP
 Van De Graaf Pit
 Midvale Rock Products
 Kittitas County, Washington
 Section 11, Township 18N, Range 18E, W.M.

DATE 02-19-07
 DWN. MPM
 APPR. RG
 PROJ. #1360.02

ECOLOGICAL LAND SERVICES, INC.
 1157 3rd Ave., Suite 220 Longview, WA 98632
 (360) 578-1371 Fax: (360) 474-9305

LEGEND:

-  PROPERTY BOUNDARY/SECTION LINE (≈636 ACRES)
-  PERMIT BOUNDARY (250 ACRES)
-  EXISTING TOPOGRAPHY (20 FT. INTERVALS)
-  FINAL TOPOGRAPHY (20 FT. INTERVALS)
-  CROSS SECTION LOCATION (SEE FIGURE 6)
-  EXISTING ROAD & CENTERLINE
-  IRRIGATION CHANNEL & FLOW DIRECTION
-  INTERMITTENT SWALE & FLOW DIRECTION
-  INFILTRATION AREAS
-  DRAINAGE PATTERNS

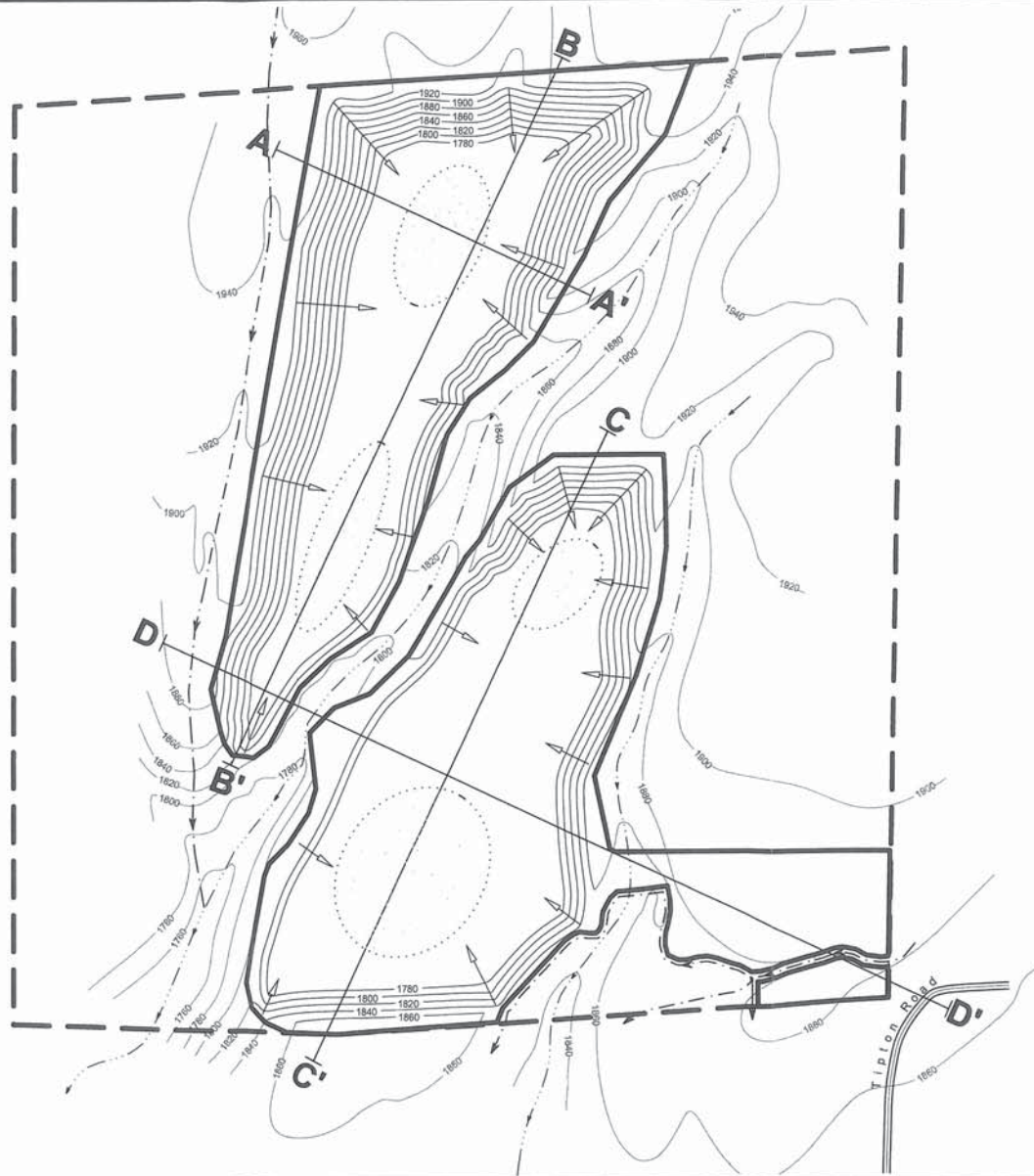

N



NOTES:

1. EXISTING AND PROPOSED BASE MAP FEATURES (PERMIT BOUNDARY, ROADS, STREAMS, DRAINAGES, ETC.) BASED ON ECOLOGICAL LAND SERVICES, INC. SITE RECONNAISSANCE, AUGUST, 2006.
2. EXISTING FEATURES WERE FIELD RECORDED BY HANDHELD GPS UNIT AND HAVE NOT BEEN SURVEYED BY A PROFESSIONAL LAND SURVEYOR.
3. EXISTING TOPOGRAPHY OBTAINED FROM USGS TOPOGRAPHIC MAP, (ELLENSBURG NORTH QUADRANGLE, 1958, PHOTOREVISED 1978) PROVIDED BY MAPTECH, INC. SOFTWARE TERRAIN NAVIGATOR PRO.

Reclamation Figure 5
FINAL TOPOGRAPHY MAP
 Van De Graaf Pit
 Midvale Rock Products
 Kittitas County, Washington
 Section 11, Township 18N, Range 18E, W.M.

DATE 02-19-07
 DWN. MPM
 APPR. RG
 PROJ. #1380.02

ECOLOGICAL LAND SERVICES, INC.
 1157 3rd Ave., Suite 220 Longview, WA 98632
 (360) 578-1371 Fax: (360) 414-9905

SITE PLAN



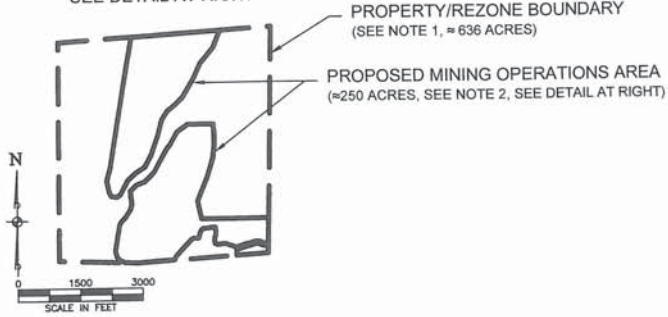









SEE DETAIL AT RIGHT

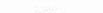

PROPERTY/REZONE BOUNDARY
(SEE NOTE 1, = 636 ACRES)

PROPOSED MINING OPERATIONS AREA
(≈250 ACRES, SEE NOTE 2, SEE DETAIL AT RIGHT)

LEGEND:

-  PROPERTY/REZONE BOUNDARY (≈636 ACRES)
-  PROPOSED PERMIT BOUNDARY (≈250 ACRES)
-  PROPOSED CUT AREA (≈ 210 ACRES, 2:1 SLOPES)
-  EXISTING TOPOGRAPHY (20 FT. INTERVALS)
-  PROPOSED FINAL TOPOGRAPHY (20 FT. INTERVALS)
-  PROPOSED PERMANENT MARKERS
(LINE OF SIGHT)
-  EXISTING ROAD (TIPTON ROAD)
-  PROPOSED SITE ACCESS ROAD
-  IRRIGATION CHANNEL & FLOW DIRECTION
-  INTERMITTENT SWALE & FLOW DIRECTION
-  PROPOSED PRODUCT STOCKPILE AREA (≈22 ACRES)
-  PROPOSED CRUSHER AREA (≈1 ACRE)
-  PROPOSED TOPSOIL STORAGE AREA (≈15 ACRES)

NOTES:

1. ENTIRE SECTION (SECTION 11, TOWNSHIP 18N, RANGE 18E, W.M.) PROPOSED FOR REZONE. NO STRUCTURES CURRENTLY EXIST WITHIN THE SECTION.
2. MINING OPERATIONS AREA IS PRIMARILY FOR PURPOSE OF DESCRIBING PROPOSED BUILDINGS AND FEATURES, AS WELL AS EXISTING CONDITIONS AROUND THE PROPOSED PERMIT BOUNDARY.
3. EXISTING AND PROPOSED BASE MAP FEATURES (PERMIT BOUNDARY, ROADS, STREAMS, DRAINAGES, ETC.) BASED ON ECOLOGICAL LAND SERVICES, INC. SITE RECONNAISSANCE, AUGUST, 2006.
4. EXISTING FEATURES WERE FIELD RECORDED BY HANDHELD GPS UNIT AND HAVE NOT BEEN SURVEYED BY A PROFESSIONAL LAND SURVEYOR.
5. EXISTING TOPOGRAPHY OBTAINED FROM USGS TOPOGRAPHIC MAP, (ELLENSBURG NORTH QUADRANGLE, 1958, PHOTOREVISED 1978) PROVIDED BY MAPTECH, INC. SOFTWARE TERRAIN NAVIGATOR PRO.



SITE PLAN DETAIL

SEE NOTE 2

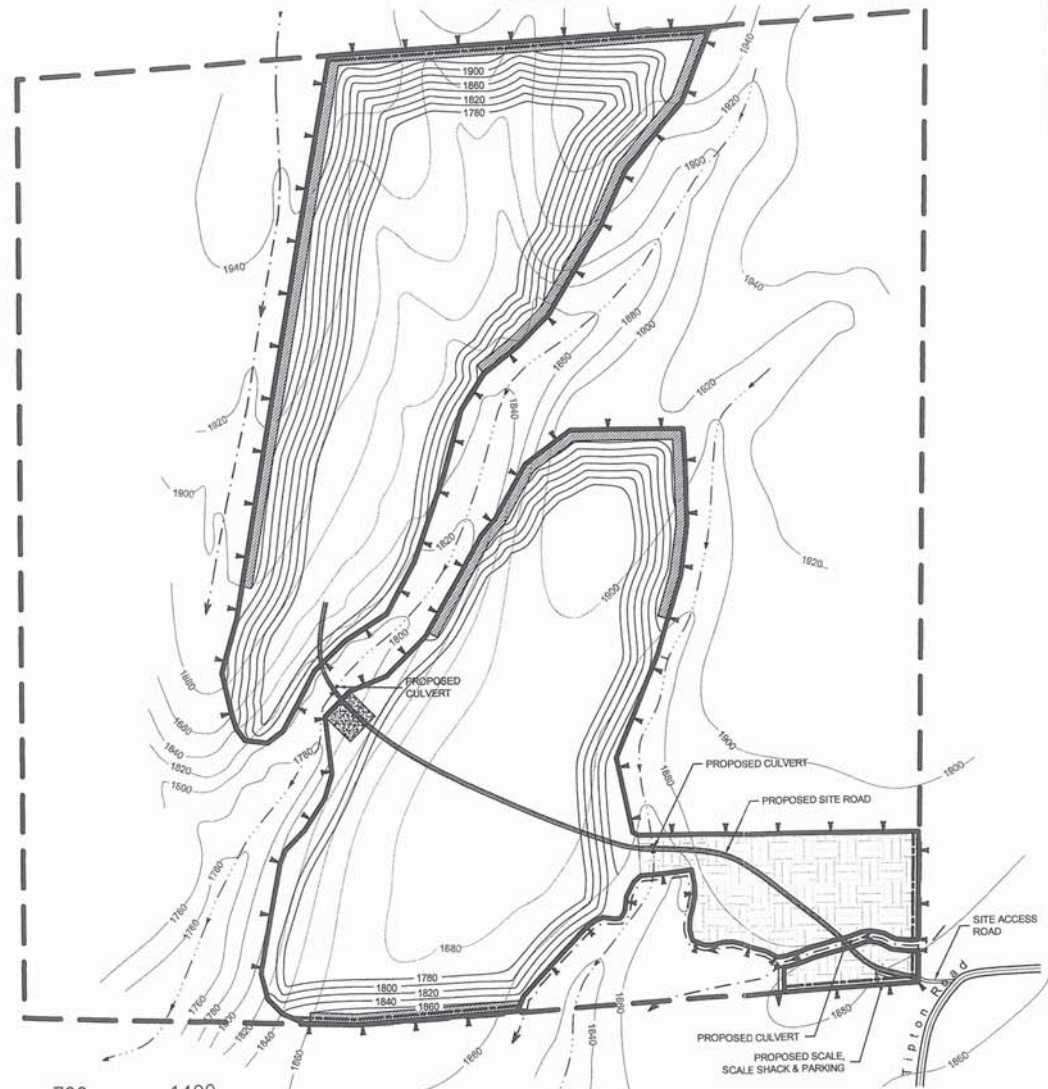

Rezone Figure 4
 SITE PLAN DETAIL
 Van De Graaf Pit
 Midvale Rock Products
 Kittitas County, Washington
 Section 11, Township 18N, Range 18E, W.M.

DATE 02-19-07
 DWN. MPM
 APPR. RG
 PROJ. # 1360.02

ECOLOGICAL LAND SERVICES, INC.
 1157 3rd Ave., Suite 220 Longview, WA 98632
 (360) 578-1371 Fax: (360) 414-9305

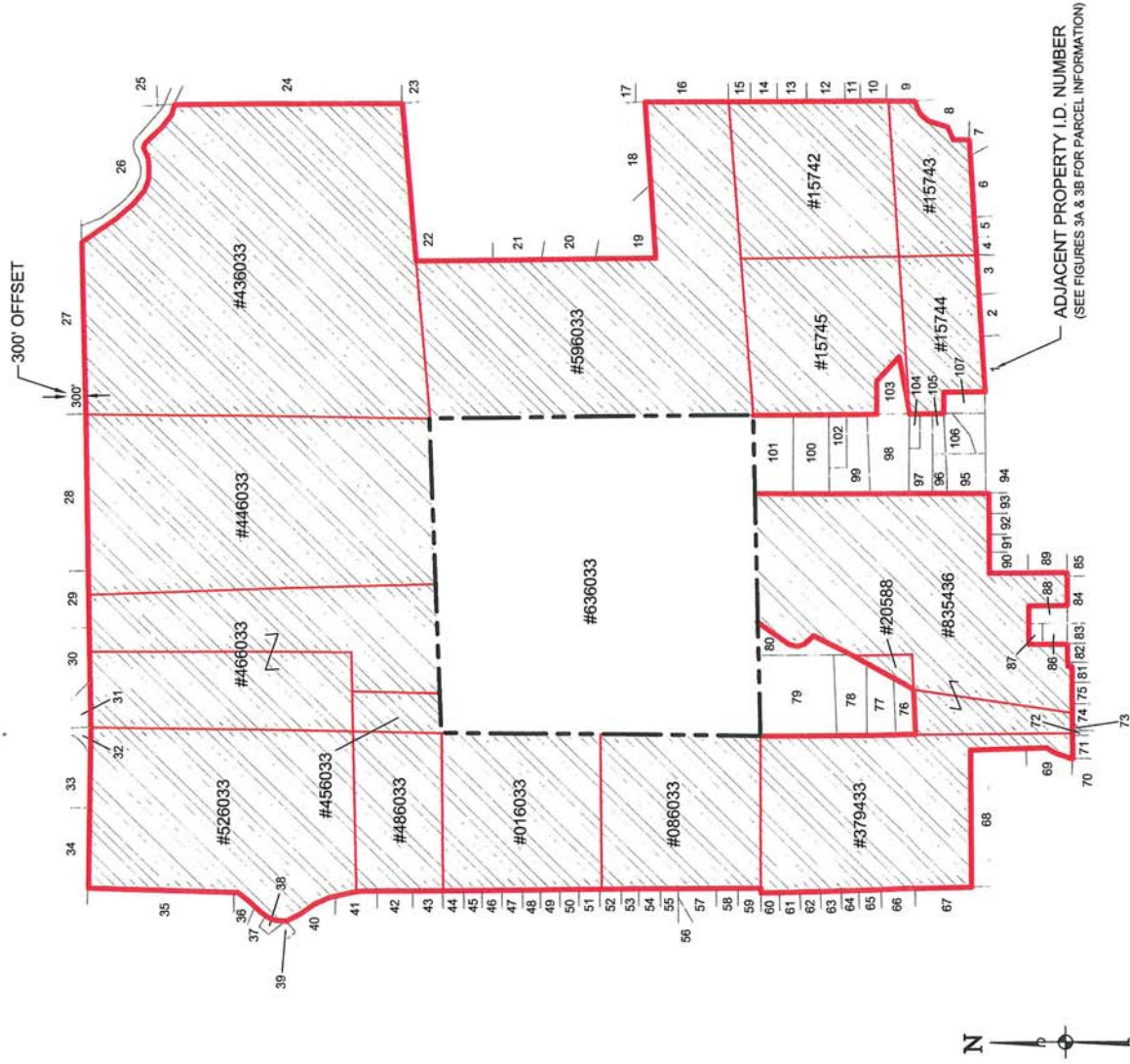

ADJACENT PROPERTY I.D. NUMBER
(SEE FIGURES 3A & 3B FOR PARCEL INFORMATION)

LEGEND:

-  PROPERTY/REZONE BOUNDARY
(636.1 ACRES)
-  CONTIGUOUS OWNERSHIP BOUNDARY
(4,070 ACRES)
-  CONTIGUOUS OWNERSHIP PARCEL LINES
-  CONTIGUOUS OWNERSHIP ASSESSOR'S PARCEL NUMBERS
-  ADJACENT PARCEL LINES
-  300' OFFSET BOUNDARY
(PER K.C.C.O)
-  ADJACENT PROPERTY I.D. NUMBERS
(SEE FIGURES 3A & 3B FOR OWNERSHIP INFORMATION)

67















NOTE: PROPERTY INFORMATION OBTAINED ONLINE PROVIDED BY KITTITAS COUNTY AT WEB ADDRESS [HTTP://WWW.CO.KITTITAS.WA.US](http://www.co.kittitas.wa.us).

ECOLOGICAL LAND SERVICES, INC.
 1157 3rd Ave., Suite 220 Longview, WA 98632
 (360) 578-1371 Fax: (360) 414-9305

DATE 02-19-07
 DWN. JTM/MPM
 APPR. RG
 PROJ. # 1360.02

Rezone Figure 3
 REZONE MAP
 Van de Graaf Pit Plan
 Midvale Rock Products
 Kittitas County, Washington
 Section 11, Township 18N, Range 18W, W.M.

LEGEND:

-  PROPERTY BOUNDARY/SECTION LINE (≈636 ACRES)
-  PERMIT BOUNDARY (250 ACRES)
-  EXISTING TOPOGRAPHY (20 FT. INTERVALS)
-  CROSS SECTION LOCATION (SEE FIGURE 6)
-  PERMANENT MARKERS (LINE OF SIGHT)
-  EXISTING ROAD & CENTERLINE
-  SITE ACCESS ROAD
-  IRRIGATION CHANNEL & FLOW DIRECTION
-  INTERMITTENT SWALE & FLOW DIRECTION
-  25' BUFFER
-  PRODUCT STOCKPILE AREA (≈22 ACRES)
-  CRUSHER AREA (≈1 ACRE)
-  TOPSOIL SOIL STOCKPILE AREAS (≈16 ACRES)
-  MINING SEGMENT BOUNDARY
- M-1** MINING SEGMENT ORDER
-  DIRECTION OF MINING
- R-1** RECLAMATION PHASE (WITH ACREAGE)

NOTES:

1. EXISTING AND PROPOSED BASE MAP FEATURES (PERMIT BOUNDARY, ROADS, STREAMS, DRAINAGES, ETC.) BASED ON ECOLOGICAL LAND SERVICES, INC. SITE RECONNAISSANCE, AUGUST, 2006.
2. EXISTING FEATURES WERE FIELD RECORDED BY HANDHELD GPS UNIT AND HAVE NOT BEEN SURVEYED BY A PROFESSIONAL LAND SURVEYOR.
3. EXISTING TOPOGRAPHY OBTAINED FROM USGS TOPOGRAPHIC MAP, (ELLENSBURG NORTH QUADRANGLE, 1958, PHOTOREVISED 1978) PROVIDED BY MAPTECH, INC. SOFTWARE TERRAIN NAVIGATOR PRO.

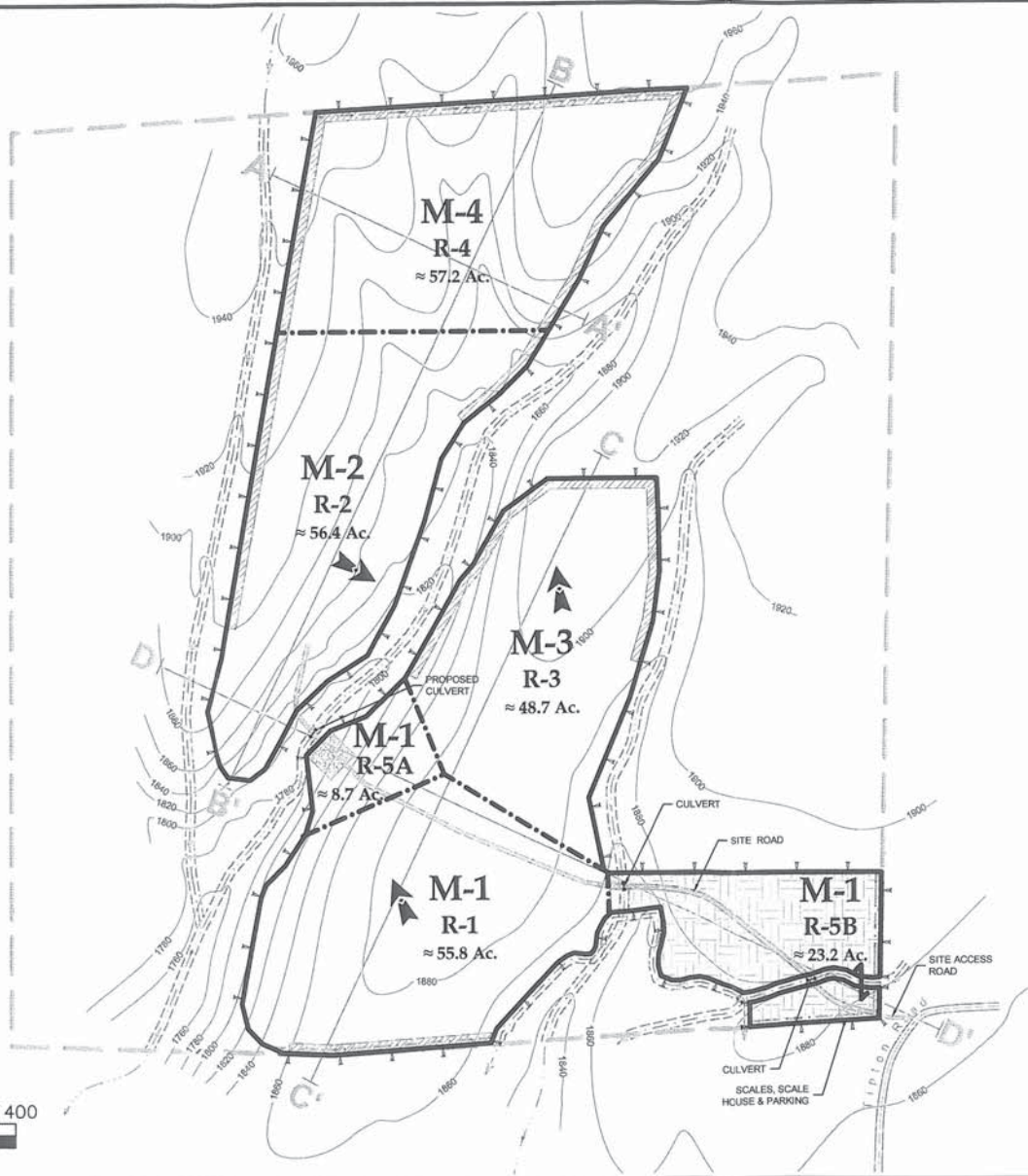
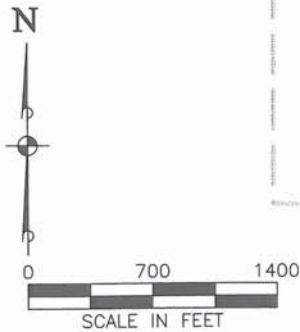

Reclamation Figure 4
RECLAMATION SEQUENCE MAP
 Van De Graaf Pit
 Midvale Rock Products
 Kittitas County, Washington
 Section 11, Township 18N, Range 18E, W.M.

DATE: 02-19-07
 DWN: MPM
 APPR: RG
 PROJ: #1380.02

ECOLOGICAL LAND SERVICES, INC.
 1157 3rd Ave., Suite 220 Longview, WA 98632
 (360) 578-1371 Fax: (360) 414-9305

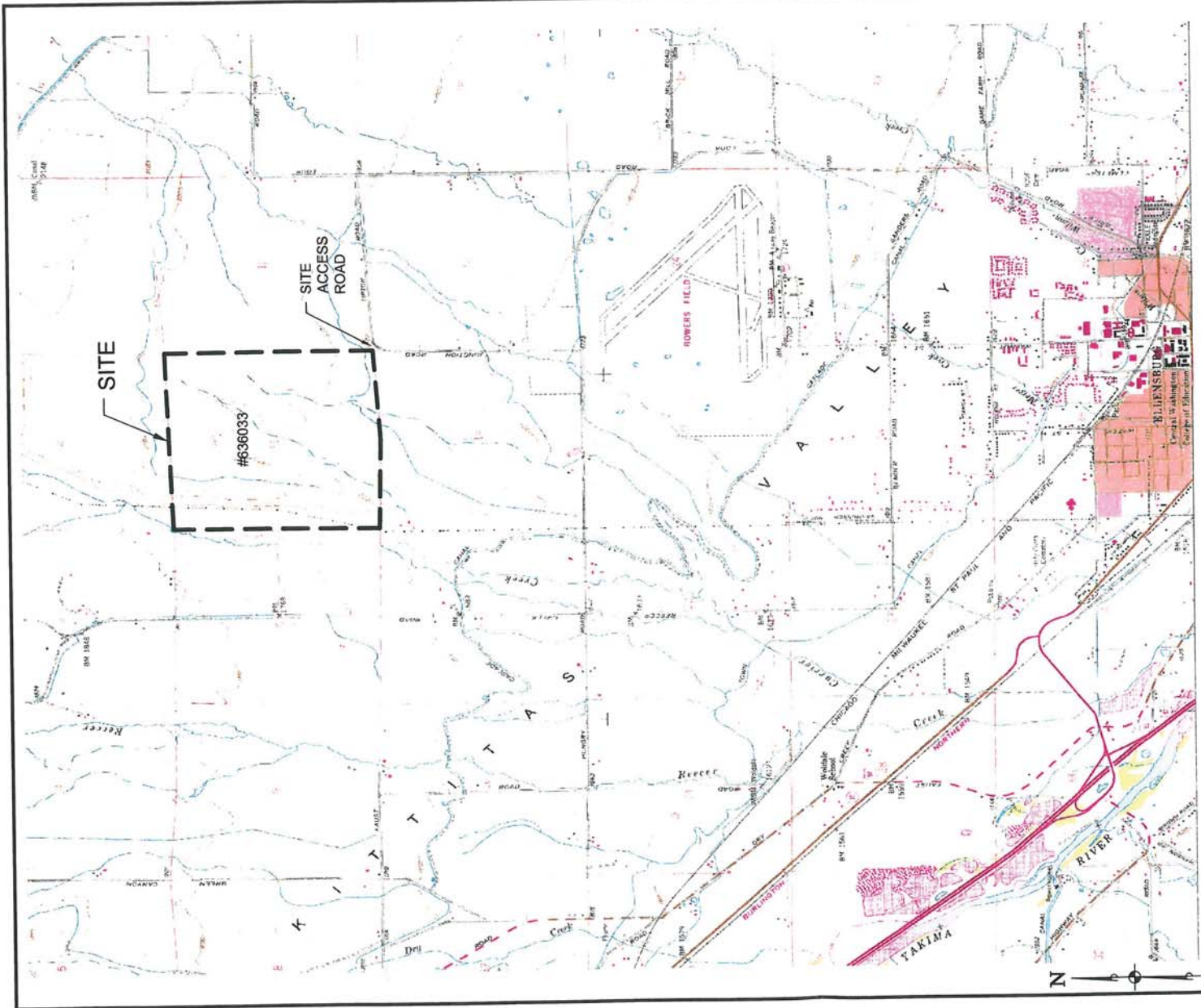

DIRECTIONS TO SITE
 SITE IS LOCATED APPROXIMATELY 5 MILES NORTH OF ELLENSBURG. DRIVE WEST FROM ELLENSBURG ONTO DRY CREEK CONNECTOR ROAD. TURN RIGHT ONTO HUNGRY JUNCTION ROAD, THEN LEFT ONTO TIPTON ROAD. SITE ACCESS ROAD IS LOCATED ON WEST SIDE OF TIPTON ROAD, APPROXIMATELY ONE MILE NORTH OF HUNGRY JUNCTION ROAD.

LEGEND:

- PROPERTY/REZONE SITE BOUNDARY (636.1 ACRES)
- #636033 KITTITAS COUNTY ASSESSOR PARCEL NUMBER

NOTE:
 USGS TOPOGRAPHIC QUADRANGLE MAP (ELLENSBURG NORTH, 1978) REPRODUCED USING MAPTECH, INC. SOFTWARE TERRAIN NAVIGATOR PRO.

ECOLOGICAL LAND SERVICES, INC.

 1157 3rd Ave., Suite 220 Longview, WA 98632
 (360) 578-1371 Fax: (360) 414-9305

DATE	02-19-07
DWN.	MPM
APPR.	RG
PROJ.	#1360.02

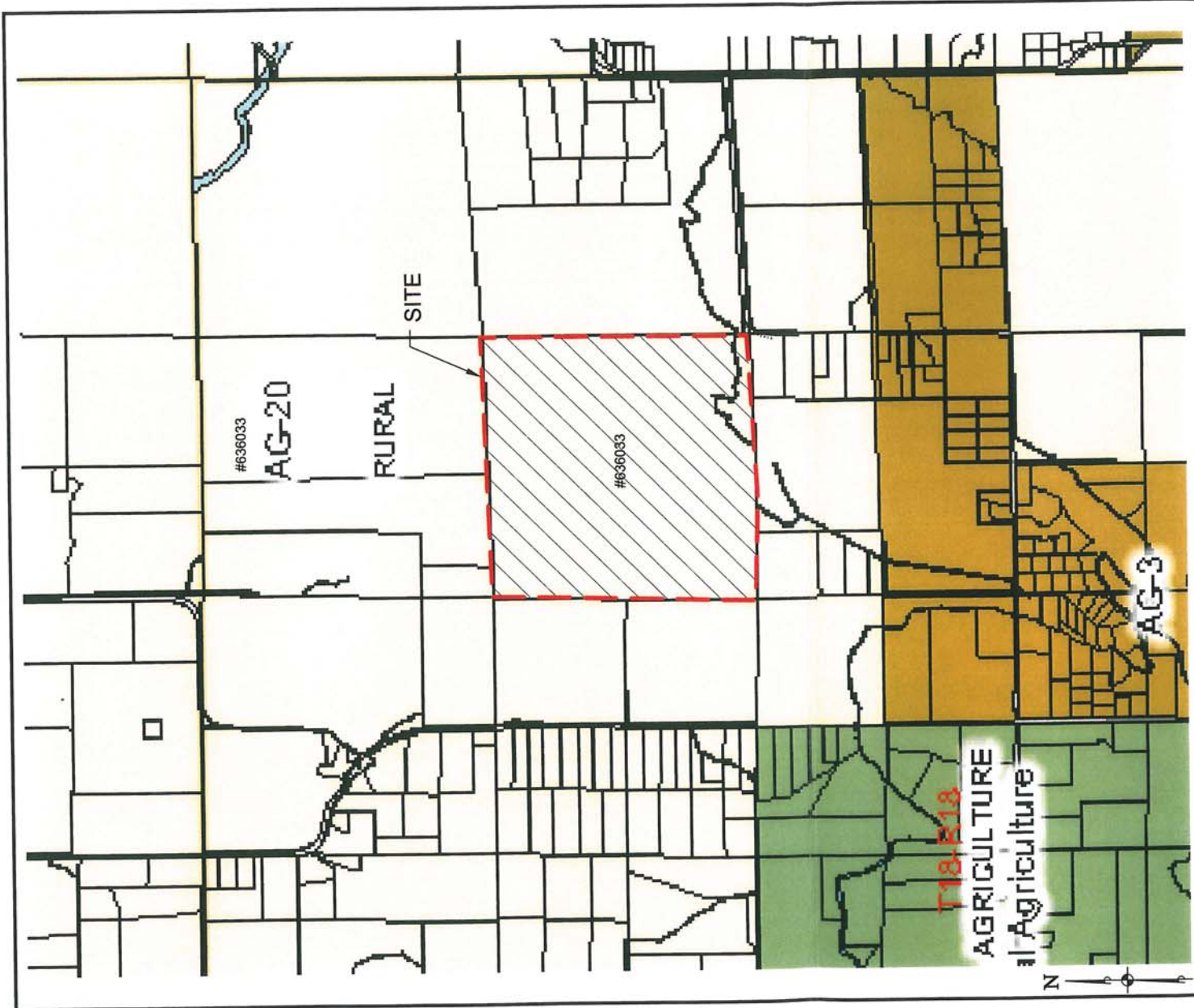
Rezone Figure 1
 VICINITY MAP
 Van de Graaf Pit Plan
 Midvale Rock Products
 Kittitas County, Washington
 Section 11, Township 18N, Range 18W, W.M.



DIRECTIONS TO SITE

SITE IS LOCATED APPROXIMATELY 5 MILES NORTH OF ELLENSBURG. DRIVE WEST FROM ELLENSBURG ONTO DRY CREEK CONNECTOR ROAD, TURN RIGHT ONTO HUNGRY JUNCTION ROAD, THEN LEFT ONTO TIPTON ROAD. SITE ACCESS ROAD IS LOCATED ON WEST SIDE OF TIPTON ROAD, APPROXIMATELY ONE MILE NORTH OF HUNGRY JUNCTION ROAD.

LEGEND:

-  PROPERTY/REZONE SITE BOUNDARY (636.1 ACRES)
-  #636033
-  KITTITAS COUNTY ASSESSOR PARCEL NUMBER
-  AG - 20
-  AG - 3
-  COMMERCIAL AGRICULTURE

NOTE:
ZONING MAP OBTAINED ONLINE PROVIDED BY KITTITAS COUNTY AT WEB ADDRESS [HTTP://WWW.CO.KITTITAS.WA.US](http://www.co.kittitas.wa.us).

ECOLOGICAL LAND SERVICES, INC.
 1157 3rd Ave., Suite 220 Longview, WA 98632
 (360) 578-1371 Fax: (360) 414-9305

DATE	02-19-07
DWN.	MPM
APPR.	RG
PROJ.	#1360.02

Rezone Figure 2
 ZONING MAP
 Van de Graaf Pit Plan
 Midvale Rock Products
 Kittitas County, Washington
 Section 11, Township 18N, Range 18W, W.M.